

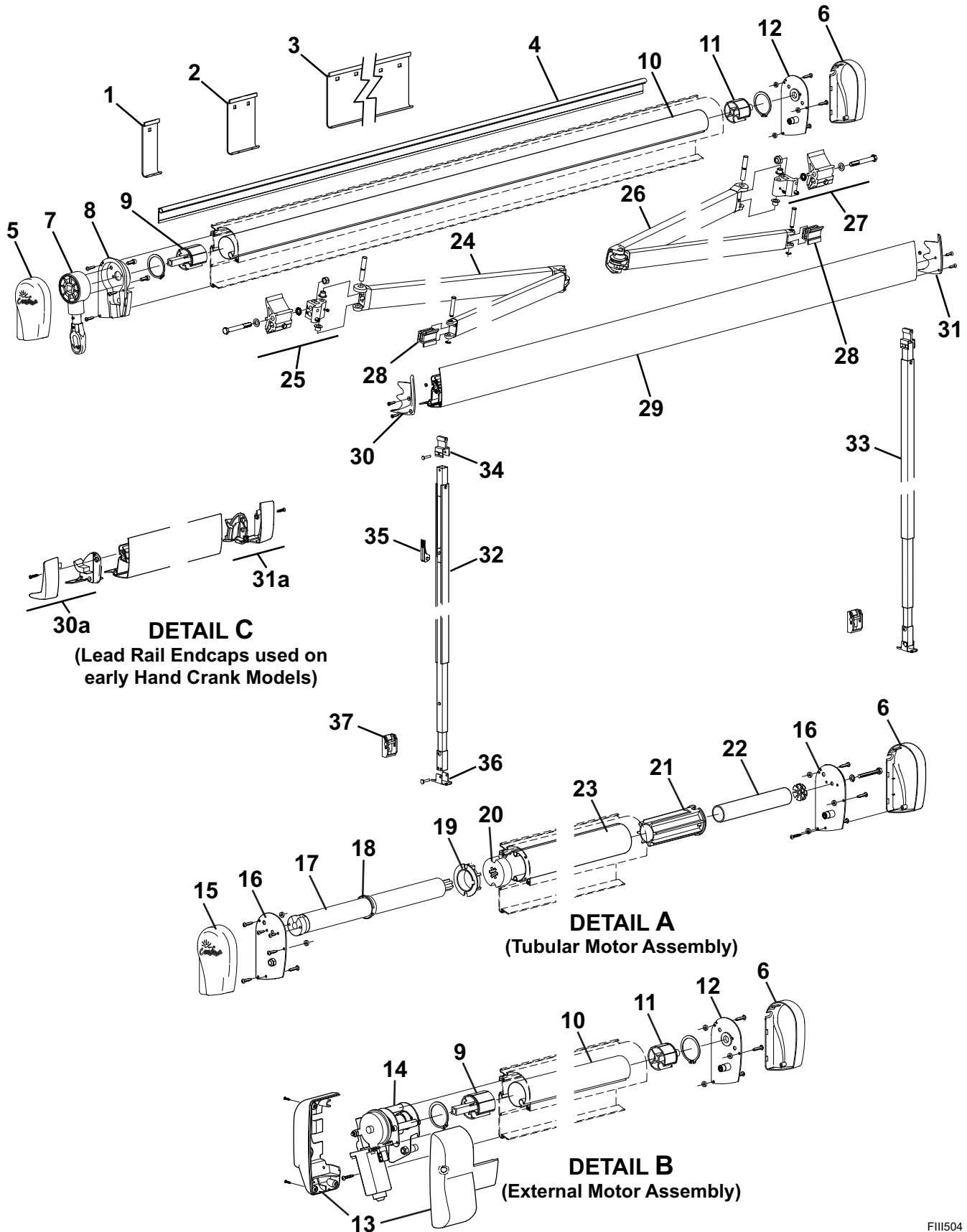

ILLUSTRATED PARTS LIST

FREEDOM SERIES

**FREEDOM SERIES PATIO AWNING ILLUSTRATED PARTS LIST**  
**- MANUFACTURED AFTER 01-09 (SERIES CODE AV)**



**DETAIL C**  
 (Lead Rail Endcaps used on  
 early Hand Crank Models)

**DETAIL A**  
 (Tubular Motor Assembly)

**DETAIL B**  
 (External Motor Assembly)

**CAREFREE OF COLORADO**

<b>Item</b>	<b>Part Number</b>	<b>Description</b>	<b>Notes</b>
	R001543	Bracket Pack	8'-9' 2
	R001544	Bracket Pack	10'-11' 2
	R001545	Bracket Pack	12'-13' 2
<b>1</b>	Available in Bracket Packs only – see note 2	Mounting Plate	1 1/2" 2
<b>2</b>		Mounting Plate	3" 2
<b>3</b>		Mounting Plate	18" 2
<b>4</b>		Awning Rail	See Hardware and Accessories
<b>5</b>		End Cap, LH	Manual Crank
<b>6</b>	R001025XXX	End Cap, RH	
<b>7</b>	R001536-XXX	Manual Crank Assy	
<b>8</b>	R001535-XXX	Manual Crank Housing	
<b>9</b>	R001538	End Plug Assembly, Roller Tube, LH	Manual Crank
<b>10</b>		Roller Tube, 1 7/8, Steel	See Hardware and Accessories
<b>11</b>	R001537	End Plug Assembly, Roller Tube, Idler	
<b>12</b>	R001539	End Plate, Housing, RH	Manual Crank
<b>13</b>	R001503XXX	End Cap Kit, 2-pieces, LH	External Motor
<b>14</b>	R001502	Motor Assy	External Motor
<b>15</b>	R001187XXX	End Cap, LH	Tubular Motor
<b>16</b>	R036425-001	End plate, Housing, Motorized, Tubular Motor	LH, RH
<b>17</b>	R001189	Motor, Tubular	3
<b>18</b>	R060448-001	Crown	
<b>19</b>	R040555-001	Drive Hub	
<b>20</b>	R040723-001	Roller Bearing	
<b>21</b>	R001188	Bushing, Roller Tube	RH
<b>22</b>	R034923-001	Pivot Tube, Roller Tube	RH
<b>23</b>		Roller Tube, 2 1/4	See Hardware and Accessories
<b>24</b>	R012530-TB68L	LH Spring Arm 8'	
	R012530-TB76L	LH Spring Arm 9'	
	R012530-TB94L	LH Spring Arm 10'-13'	
<b>25</b>	R019268-001	Connector Assy, Housing	LH
<b>26</b>	R012530-TB68R	RH Spring Arm 8'	
	R012530-TB76R	RH Spring Arm 9'	
	R012530-TB94R	RH Spring Arm 10'-13'	
<b>27</b>	R019268-101	Connector Assy, Housing	RH
<b>28</b>	R019269-001	Connector Assy, Lead Rail	
<b>29</b>	R001585XXX-xxx	Lead Rail, Outer	1
	R001586XXX-xxx	Lead Rail, Inner	1
<b>30</b>	R001541-XXX	End Plate, Lead Rail	LH
<b>30a</b>	R001027XXX	End Plate, Lead Rail	SEE NOTE 6 LH 4
<b>31</b>	R001542-XXX	End Plate, Lead Rail	RH
<b>31a</b>	R001028XXX	End Plate, Lead Rail	SEE NOTE 6 RH 4
<b>32,33</b>		Ground Support	
		Awning Length	(32) LH (33) RH
		8 foot	R00201 R00205
		9 foot	R00202 R00206
		10-11 feet	R00203 R00207
		12-13 feet	R00204 R00208
<b>34</b>	R00353	Pivot Block	
<b>35</b>	R00144	Flipper Latch Assy	
<b>36</b>	R00394	Carport Foot	
<b>37</b>	R00038	Bottom Bracket	Qty 1
<b>38</b>		Hand Crank Assembly	See Hardware and Accessories

- Notes:
1. XXX = Color; xxx = Length in inches.
  2. Bracket Pack (R001543) for 4'-9' includes 1 ea item 1 2 ea item 2  
 Bracket Pack (R001544) for 10'-11' includes 1 ea item 1 2 ea item 3  
 Bracket Pack (R001545) for 12'-13' includes 2 ea items 1, 3  
 All packs include carriage bolts, washers and nuts.
  3. Motor assembly (item 17) includes items 18, 19 and 20)
  4. Plastic lead rail plates (30a, 31a) used on early hand crank models.